

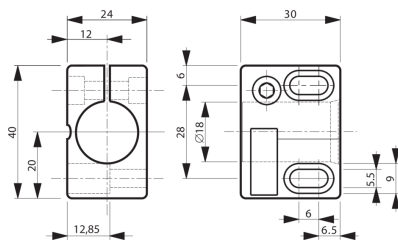

## 201623 SH 18 Sensor holder

- For cylindrical sensors of Ø 18 mm or thread M18
- Quick commissioning
- Reduced assembly / downtime due to one-piece construction
- Sensor replacement without changing the clamp position
- Slots permit clamp adjustment



### Technical data (typ.)

Hole spacing	28 mm
Mounting	Hole
Housing dimensions	24 x 30 x 40 mm
Clamping diameter	G: 18 mm
Housing material	Plastic (PA, 6 GK)
Component	Sensor holder
Characteristics	without limit stop
To be used for	Sensors with thread M18
Scope of delivery	Sensor holder

### +20°C

### More information / accessories

<https://www.di-soric.com/201623>