

MZ-K-14/6.5

Sensorkralle
Sensor bracket
Pince de détecteur

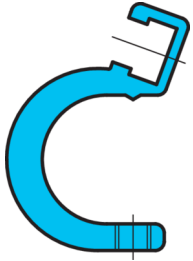

di-soric GmbH & Co. KG
Steinbeisstraße 6
DE-73660 Urbach
Germany
Tel: +49 (0) 7181/9879-0
info@di-soric.com · www.di-soric.com

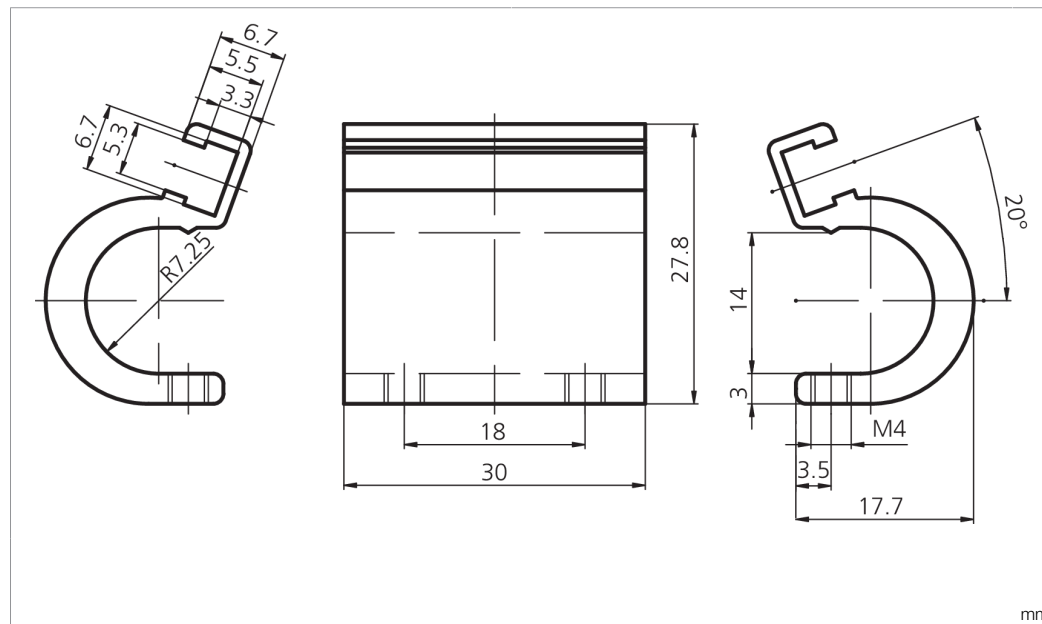

| Technische Daten | Technical data | Caractéristiques techniques | |
|------------------|-------------------|-----------------------------|---|
| Komponente | Component | Composants | Sensorkralle / Sensor bracket / Pince de détecteur |
| Montage | Assembly | Montage | an Profizylindern / at profiled cylinders / Aux vérins profilés |
| Geeignet für | To be used for | Convient pour | Ø 50-63 mm |
| Material | Material | Matériau | Aluminium / Aluminum / Aluminium |
| Lieferumfang | Scope of delivery | Contenu de la livraison | Sensorkralle, Befestigungsmaterial / Sensor bracket, Fixing material / Pince de détecteur, Matériel de fixation |

Stand 29.06.22, Änderungen vorbehalten
As of 06/29/22, subject to change
État 29.06.22, sous réserve de modifications



MZ-K-14/6.5

传感器夹爪

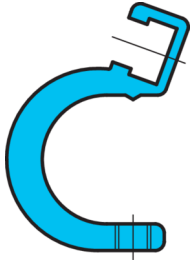

di-soric GmbH & Co. KG
 Steinbeisstraße 6
 DE-73660 Urbach
 Germany
 Tel: +49 (0) 7181/9879-0
 info@di-soric.com · www.di-soric.com

202793

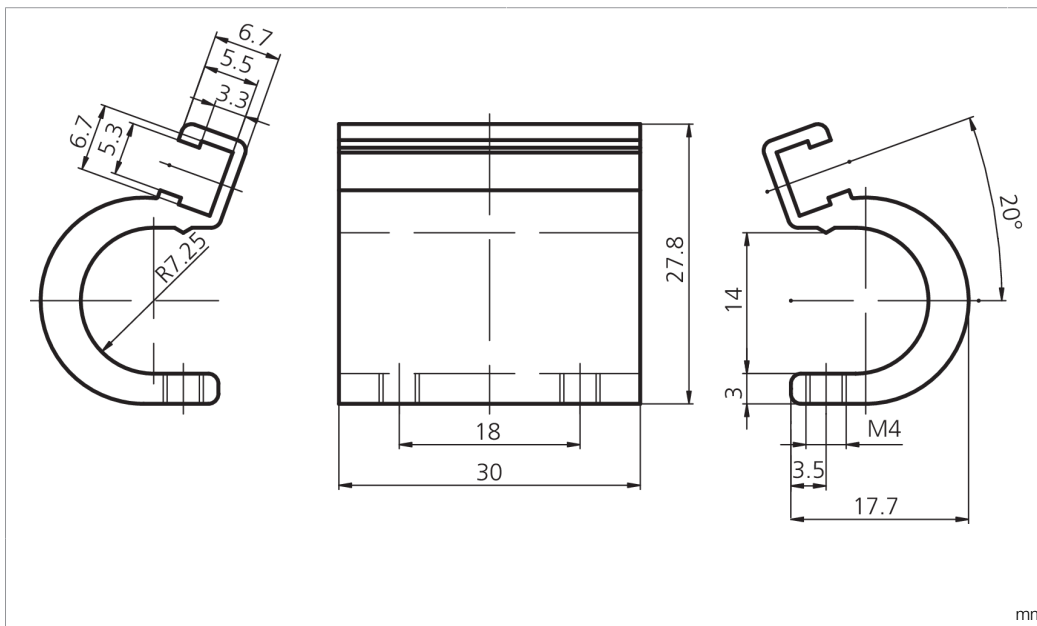

技术数据

| | |
|------|-------------|
| 组件 | 传感器夹爪 |
| 装配 | 在异型气缸上 |
| 适用于 | Ø 50-63 mm |
| 材料 | 铝 |
| 供货范围 | 传感器夹爪, 固定材料 |

版本 22.06.29, 保留变更权